

H.P.	Volts	Amps	RPM	Spd.	Model	Fig.	Type	Mtg.	Dia.	Rot.	"A" Dim	Shaft Dia. and Length	Reference No.
MUELLER													
1/12/120 in/lbs	115/230	1.85 1.0	36	1	V44-36*	J	SP	Lug	-	C.C.W.	8-7/8	3/4 x 2-3/16	Mueller V01535A144(30152) GritonV01734AC44 Babson V00827AA44

NESBITT/BLOWER WHEELS						
Model	Diameter	Width	Rot.	Fig.	Bore	Replaces
2-6139	6-5/16	6-1/4	C.C.W.	A	3/4	HVAC Wall and Ceiling units

H.P.	Volts	Amps	RPM	Spd.	Model	Fig.	Type	Mtg.	Dia.	Rot.	"A" Dim	Shaft Dia. and Length.	Reference No.
NORDYNE													
—	115	1.1	3000	1	A131	K	—	SP	3.3	C.W.	—	—	7021-9132, 7021-10171, 7021-10159, 7021-9661
—	115	1.1	3000	1	A132	L	—	SP	3.3	C.W.	—	—	7021-7973

NUTONE													
H.P.	Volts	Amps	RPM	Spd.	Model	Fig.	Type	Mtg.	Dia.	Rot.	"A" Dim	Shaft Dia. and Length.	Reference No.
▶ .75" (STACK)	120	.9	3000	1	K109	B	SP	Stud	-	C.C.W.	C Frame	.2178 x 2.37	C-68626, C-68627 9425F, 9415F, VENT. 9424FA, 9415FA FAN
▶ .55" (STACK)	120	1.1	3000	1	K111	C	SP	Stud	-	C.C.W.	C Frame	.2178 x 1.94	65878 • VENT FAN
▶ 1.00" (STACK)	120	1.0	3000	2	K112	D	SP	Stud	-	C.W.	C Frame	.2178 x 1.46	52367 RANGE HOOD
▶ .75" (STACK)	120	1.2	3000	1	K113	E	SP	Stud	-	C.C.W.	C Frame	.2178 x 1.15	63675, 9605-N 9665-N VENT, FAN
▶ 1/100	115	.6	1500	1	D540	I	SP	Stud	3.3	C.W.	2-1/8	1/4-2-1/4	Bathroom and Kitchen Vents
▶ 1/100	115	.6	1500	1	D541	I	SP	Stud	3.3	C.C.W.	2-1/8	1/4-2-1/4	26750 Bathroom and Kitchen Vents
▶ 1/100	115	.65	1550	1	D1109	F	SP	Stud	3.3	C.C.W.	2-1/16	1/4 x 3/4	23405, 23388
▶ 1/50-1/100	115	.9-5	3000	2	D1106	G	SP	Stud	3.3	C.W.	2-9/16	1/4 x 1-3/16	26733, RANGE HOOD FAN MOTORS
▶ 1/10	115	3.2	1550	1	D1107*	H	SP	Band	3.3	C.C.W.	4.00"	5/16 x 1-3/8	Nutone 67176, 32997 UE-JA25034N, JB2K016N

• Ball bearing motor

NOTE: Rotation is determined by looking at shaft end. Shaft length is measured from motor face.



Fig. A 2-6139



Fig. C K111



Fig. E K113



Fig. G D1106



Fig. I D540, D541



Fig. K A131



Fig. B K109



Fig. D K112



Fig. F D1109



Fig. H D1107



Fig. J V44-36



Fig. L A132

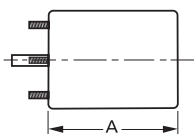

Products on this page are NOT SUITABLE for unattended equipment unless indicated by ▶ symbol. See inside back cover for additional information.

PSC motors use 5M 370V capacitors unless otherwise indicated.